

Soils Map

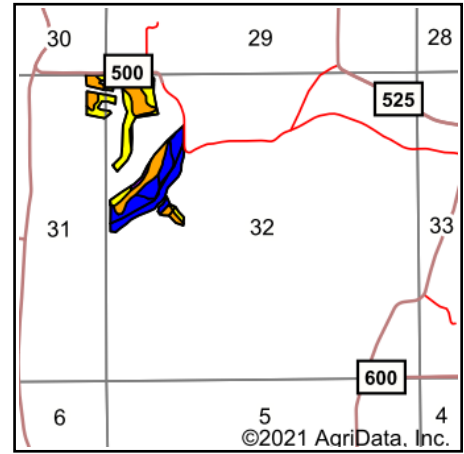
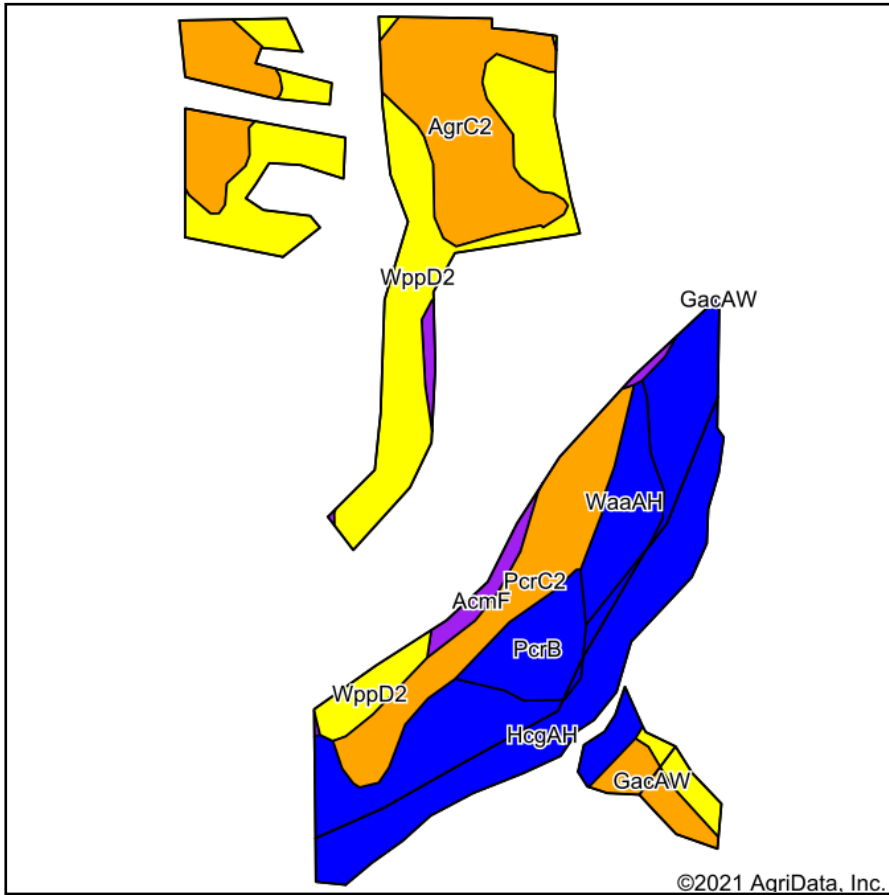

State: **Indiana**
 County: **Orange**
 Location: **32-1N-2W**
 Township: **Jackson**
 Acres: **40.72**
 Date: **1/5/2021**

LANDPROZ.COM
 Agricultural & Recreational Real Estate / Auctions / Farm Management

Maps Provided By:

 CUSTOMIZED ONLINE MAPPING
 © AgriData, Inc. 2020 www.AgriDataInc.com



Soils data provided by USDA and NRCS.

Code	Soil Description	Acres	Percent of field	Non-Irr Class Legend	Non-Irr Class *c	Alfalfa hay	Corn	Grass legume hay	Pasture	Soybeans	Winter wheat	*n NCCPI Overall	*n NCCPI Corn	*n NCCPI Small Grains	*n NCCPI Soybeans	*n NCCPI Cotton
HcgAH	Haymond silt loam, 0 to 2 percent slopes, frequently flooded, brief duration	11.40	28.0%		Ilw		120			42		94	94	52	78	70
WppD2	Wellston-Adyeville-Ebal silt loams, 12 to 18 percent slopes, eroded	10.72	26.3%		IVe		94	3	6	33	38	51	51	49	40	42
AgrC2	Apalona-Zanesville silt loams, 6 to 12 percent slopes, eroded	7.84	19.3%		Ille	6	117	4	8	41	53	48	47	48	34	24
PcrC2	Pekin silt loam, 6 to 12 percent slopes, eroded	4.51	11.1%		Ille		116	4	8	40	52	53	51	53	36	21
PcrB	Pekin silt loam, 2 to 6 percent slopes	2.12	5.2%		Ile		131	4	7	46	52	68	62	68	52	26
WaaAH	Wakeland silt loam, 0 to 2 percent slopes, frequently flooded, brief duration	2.08	5.1%		Ilw		130			39		91	91	40	73	55



GacAW	Gatchel loam, 1 to 3 percent slopes, occasionally flooded, very brief duration	1.04	2.6%		Illw	4	115			40		63	63	50	39	54
AcmF	Adyeville-Wellston silt loams, 18 to 50 percent slopes	1.01	2.5%		Vlle		4			2	1	22	21	18	13	17
Weighted Average						1.3	110.2	2.2	4.4	38.2	28.7	*n 65.2	*n 64.4	*n 49.9	*n 50.7	*n 43.6

*n: The aggregation method is "Weighted Average using all components"

*c: Using Capabilities Class Dominant Condition Aggregation Method

Soils data provided by USDA and NRCS.