

TILE INSTALLATION RECORD • LOCATION PLAN

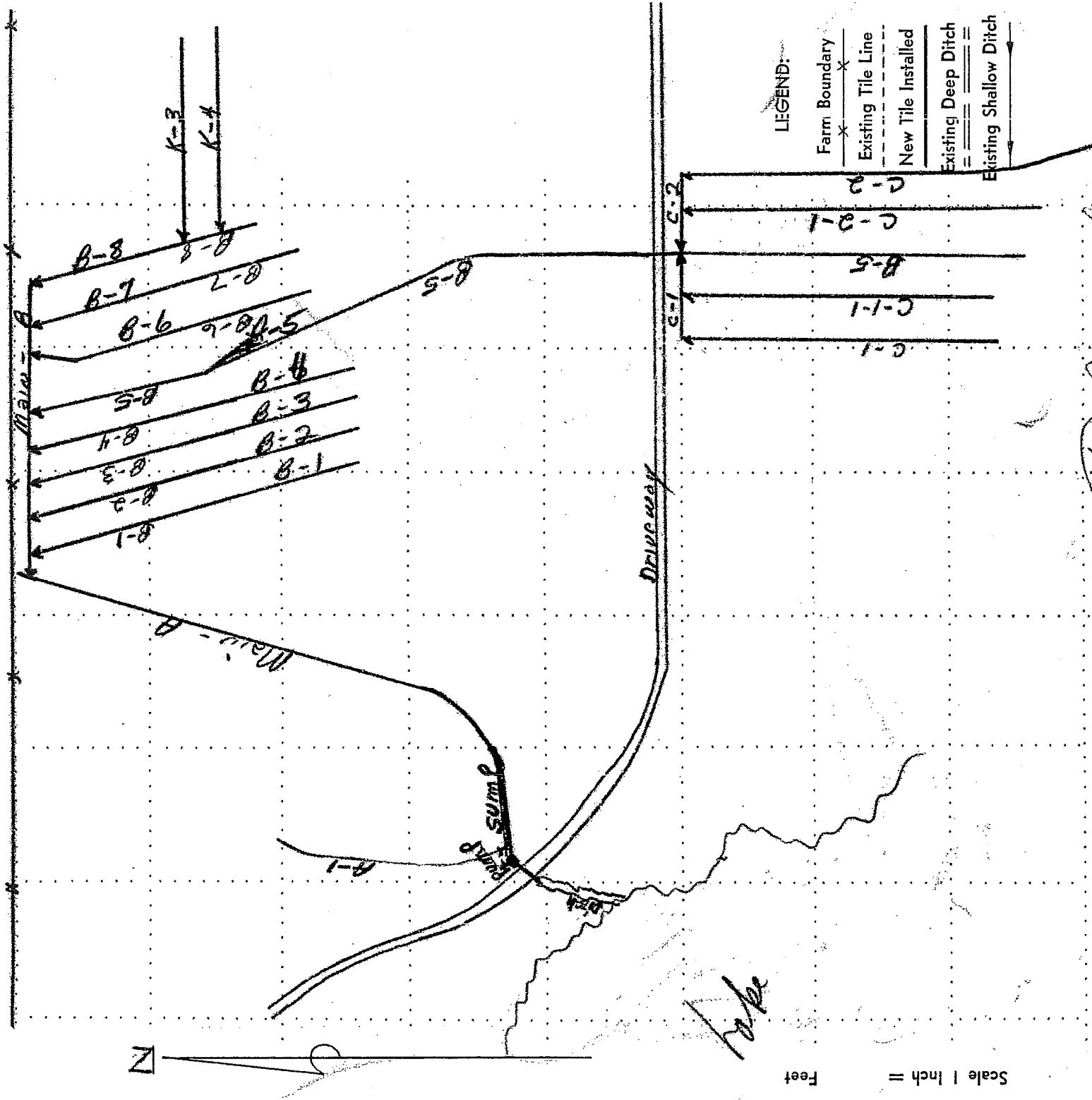

Scale 1 inch = 100 feet

LEGEND:

- Farm Boundary
- Existing Tile Line
- New Tile Installed
- Existing Deep Ditch
- Existing Shallow Ditch

Job Name Francis Roziolek  
 Sec. Freeborn Township Carlston  
 County Freeborn State Minn  
 Design By Phil Morreim

Amount of Tile Installed  
 \_\_\_\_\_ Feet of \_\_\_\_\_ inch tile  
 \_\_\_\_\_ Feet of \_\_\_\_\_ inch tile  
 \_\_\_\_\_ Feet of \_\_\_\_\_ inch tile

By Phillip Morreim 12.75  
 (Signature of Contractor and Date)

FARM DRAINAGE SERVICE, INC.

Phillip Morreim  
 Box 164, Rte. 2, Albert, Lea,  
 Minnesota 56007  
 Phone (507) 826-3449  
 (Manchester)

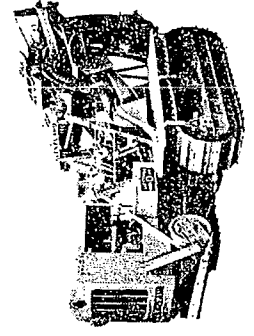

↑ NW

LINE ONLY

95' 4" Rock

Hooked up 40' 4"

70' 4"

65' 4"

425' 4"

245' 4" 100' 5" 255' 5"

365' 4" 255' 4"

365' 4" 255' 1"

345' 4" 255' 4"

340' 4" 255' 4"

305' 4" 255' 4"

290' 4" 250' 4"

275' 4" 240' 4"

130' 5"

145' 5" Hooked up Present 6"

Line Fence

Rock

Rock

350' 4"

660' 4"

70' Culvert

Grove

Present Lines

150'

TILE INSTALLATION RECORD • LOCATION PLAN

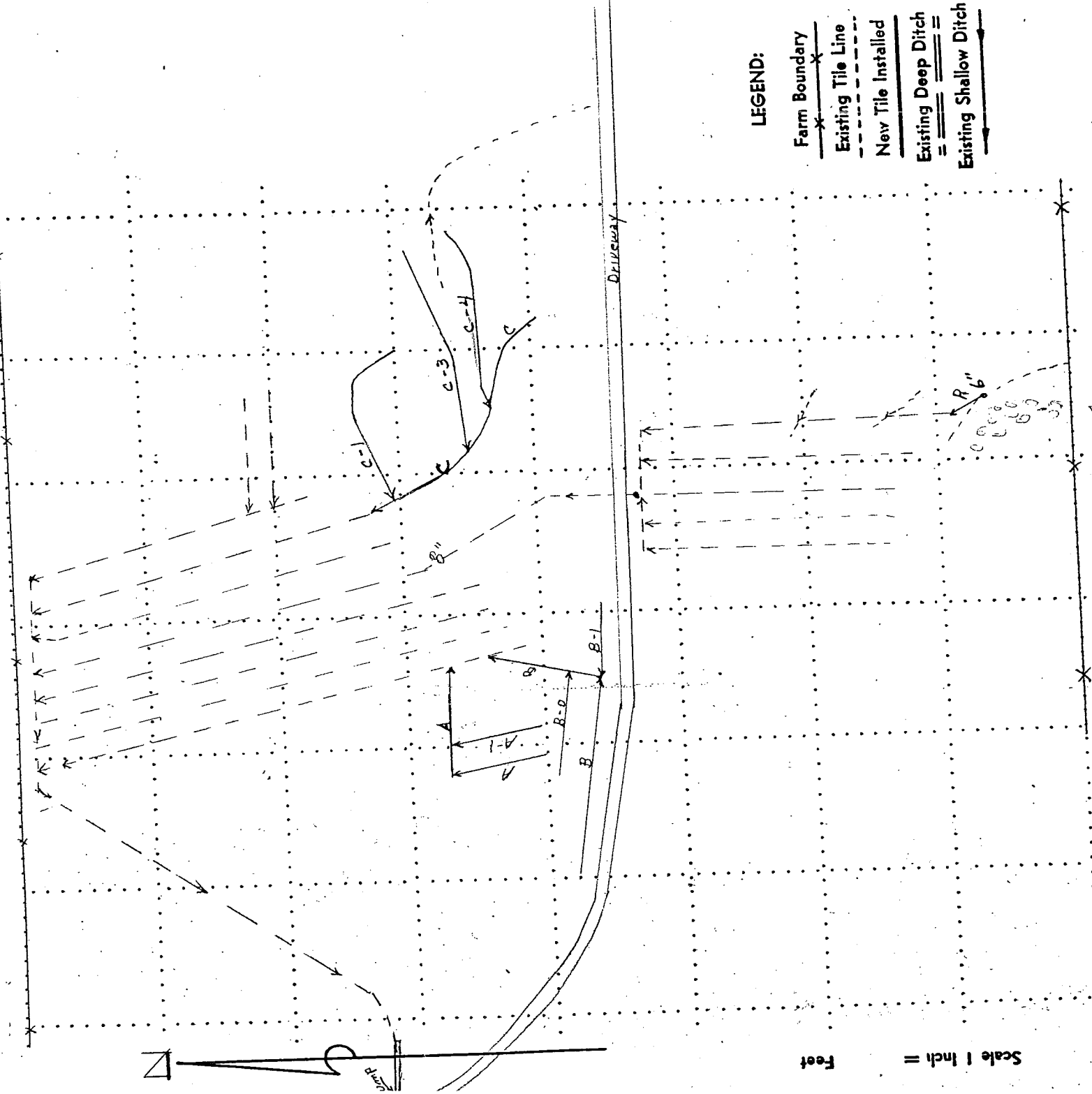

- LEGEND:
- Farm Boundary
  - Existing Tile Line
  - New Tile Installed
  - Existing Deep Ditch
  - Existing Shallow Ditch

By Phillip Morreim Dec. 1988  
 (Signature of Contractor and Date)

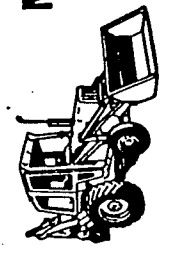

**MORREIM DRAINAGE**  
 R.R.2 Box 164  
 Albert Lea, MN 56007

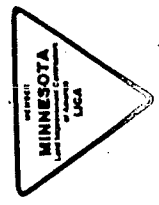

Phone (507) 826-3449  
 (Manchester)

Job Name Francis Keziok  
 Sec. 12 Township Carlston  
 County Freeborn State Minnesota  
 Design By Phil Morreim

Amount of Tile Installed Plow

_____ Feet of _____ inch tile
<u>400</u> Feet of <u>Plastic 4</u> inch tile
<u>80</u> Feet of <u>Plastic 6</u> inch tile

TILE INSTALLATION RECORD • LOCATION PLAN

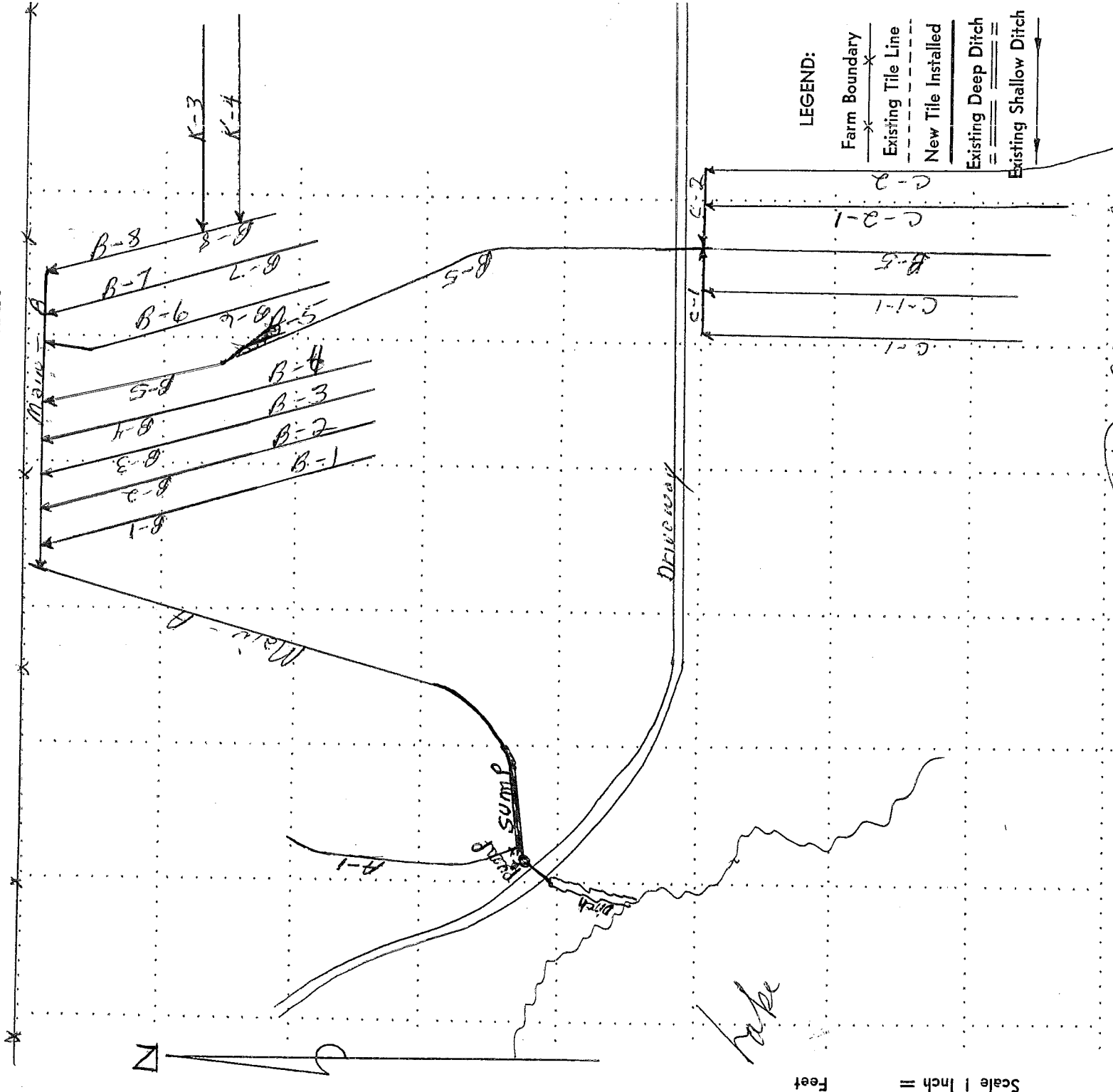

Scale 1/2 inch = 1 foot

Job Name Francis Koziak  
 Sec. 1 Township Carlston  
 County Freeborn State Minn  
 Design By Phil Morreim

Amount of Tile Installed  
 \_\_\_\_\_ Feet of \_\_\_\_\_ inch tile  
 \_\_\_\_\_ Feet of \_\_\_\_\_ inch tile  
 \_\_\_\_\_ Feet of \_\_\_\_\_ inch tile

By Philip Morreim 12-75  
 (Signature of Contractor and Date)

**FARM DRAINAGE SERVICE, INC.**

Phillip Morreim  
 Box 164, Rte. 2, Albert Lea,  
 Minnesota 56007  
 Phone (507) 826-3449  
 (Manchester)

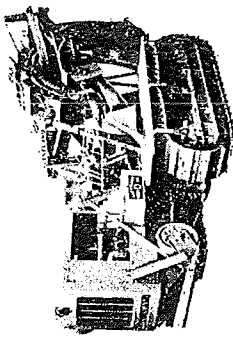

# Tile Installation Record - Location Plan

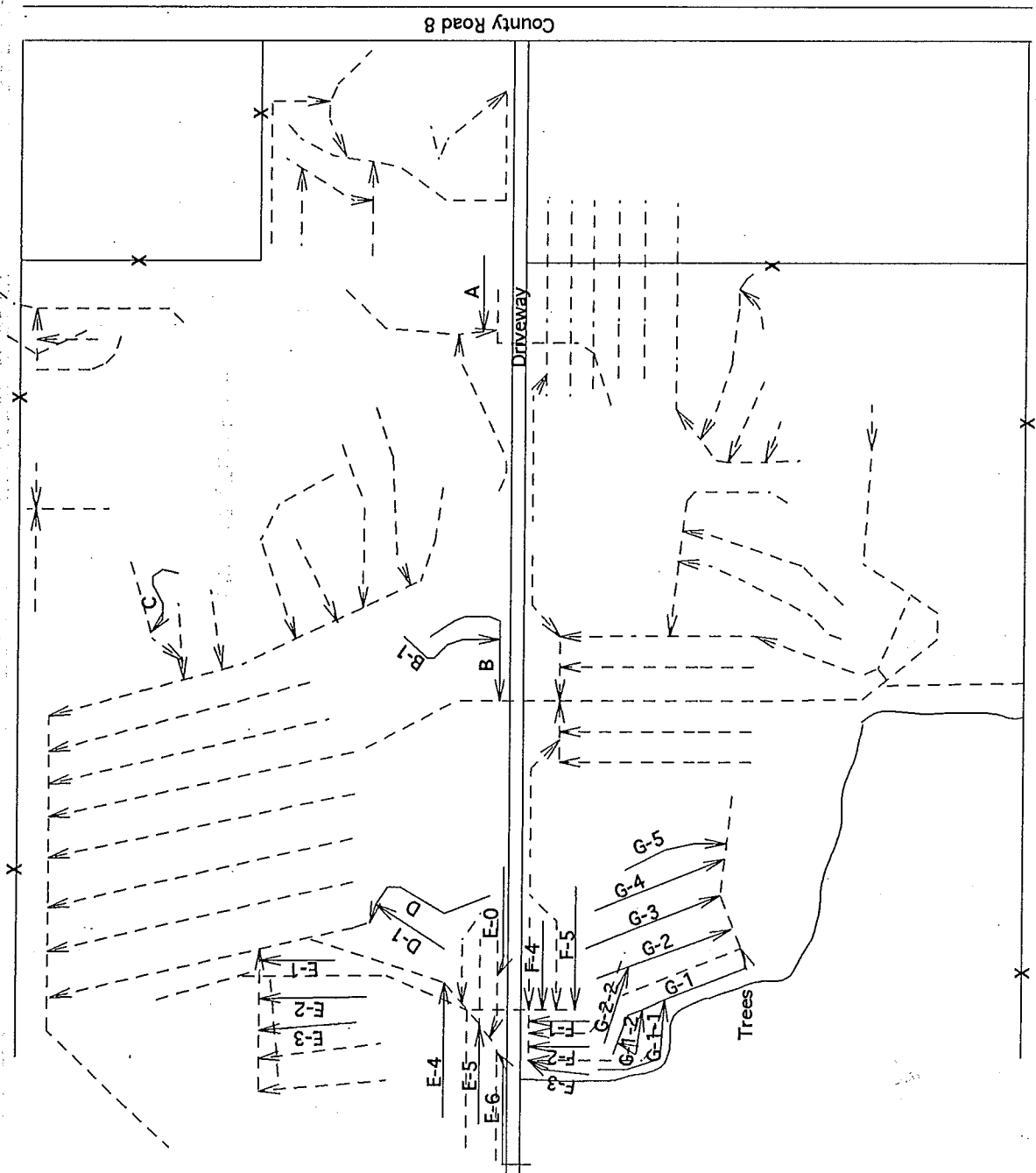

Scale  
1 inch = 440 feet

**LEGEND**

Farm Boundary  
-X---X---X-

Existing Tile Line  
- - - - -

New Tile Installed  
\_\_\_\_\_

Job Name Francis Koziolk

Sec. 11,12 Township Carlston

County Freeborn State MN

Amount of Tile Installed 7285 FT Plowed

2440	Feet of	Muck Filter	4	inch tile
4845	Feet of	Plastic	4	inch tile
	Feet of			inch tile
	Feet of			inch tile
	Feet of			inch tile

Water Management Maintains Water Quality

By Phillip Morreim 11-23-95  
(Signature of Contractor and Date)

**MORREIM DRAINAGE, INC.**  
Water Management Specialists

RR 2 Box 164  
Albert Lea, MN 56007  
Phone (507) 826-3449  
Fax: (507) 826-3482

# Tile Installation Record - Location Plan

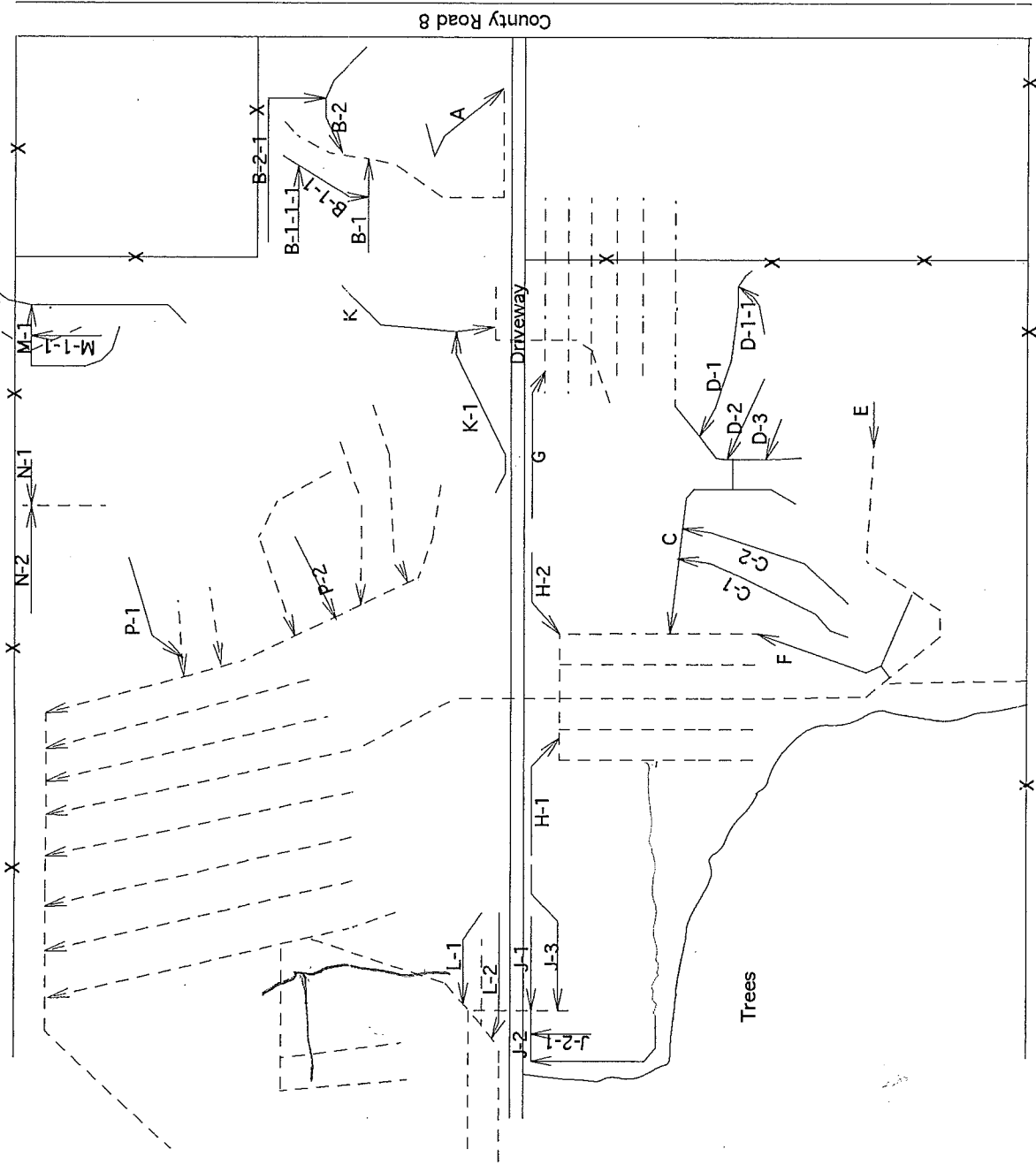

Scale  
1 inch = 440 feet

**LEGEND**

- Farm Boundary
- X---X---X---
- Existing Tile Line
- 
- New Tile Installed

Job Name Francis Koziolk

Sec. 11,12 Township Carlston

County Freeborn State MN

Amount of Tile Installed 14210 FT Plowed

1080	Feet of	Plastic 5	inch tile
12880	Feet of	Plastic 4	inch tile
250	Feet of	Filter 4	inch tile
	Feet of		inch tile
	Feet of		inch tile

Water Management Maintains Water Quality

By Phillip Morrison 5-27-93  
(Signature of Contractor and Date)

**MORREIM DRAINAGE, INC.**  
Water Management Specialists

RR 2 Box 164  
Albert Lea, MN 56007

Phone (507) 826-3449

Fax: (507) 826-3482

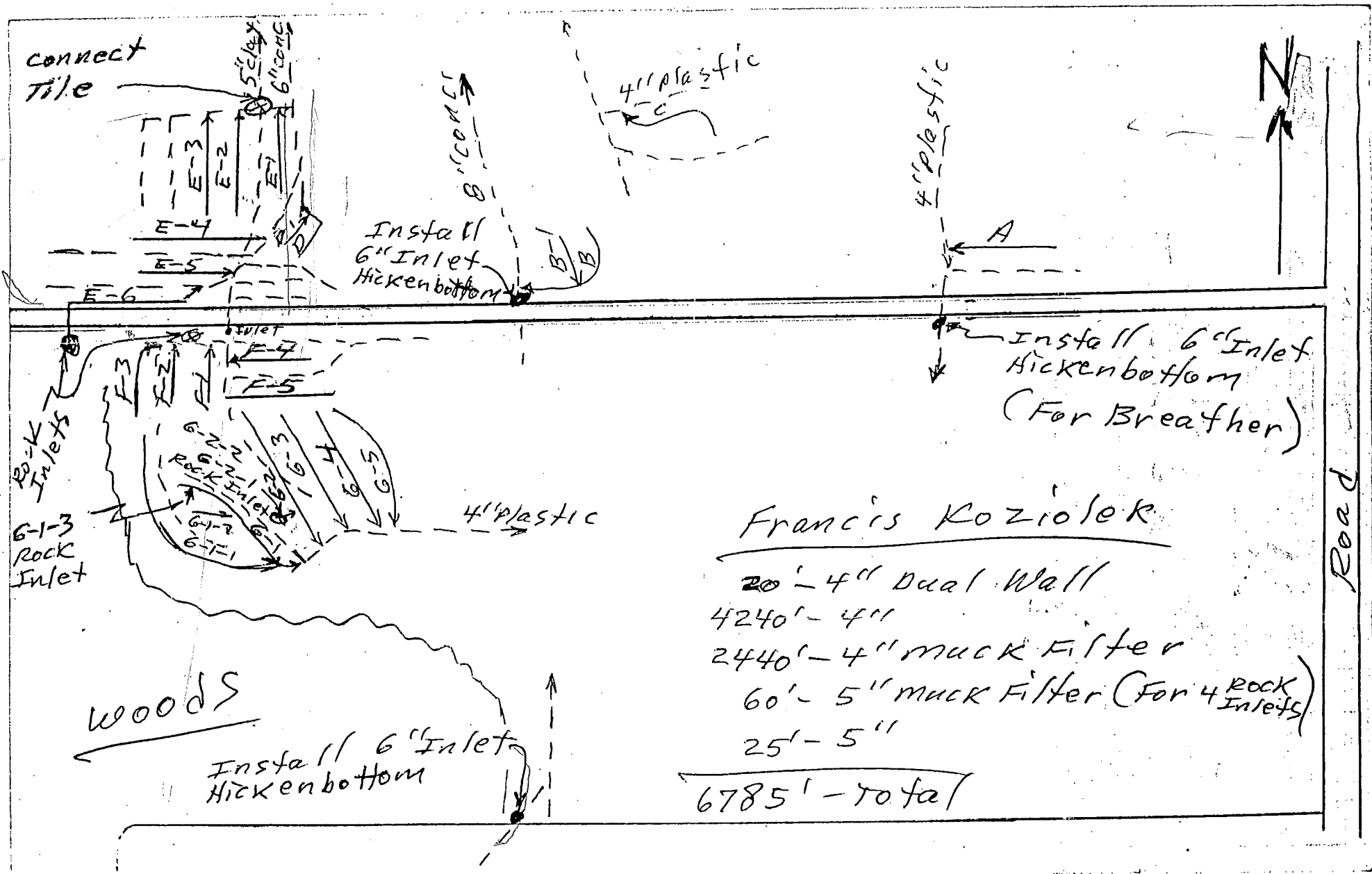

connect  
tile

4" plastic

Install  
6" Inlet  
Hickenbottom

Install 6" Inlet  
Hickenbottom  
(For Breather)

Back  
Inlets  
6-1-3  
Rock  
Inlet

4" plastic

woods

Install 6" Inlet  
Hickenbottom

Francis Koziolok

- 20' - 4" Dual Wall
- 4240' - 4"
- 2440' - 4" muck Filter
- 60' - 5" muck Filter (For 4 Rock Inlets)
- 25' - 5"

---

- 6785' - total

Road

