

# Soils Map

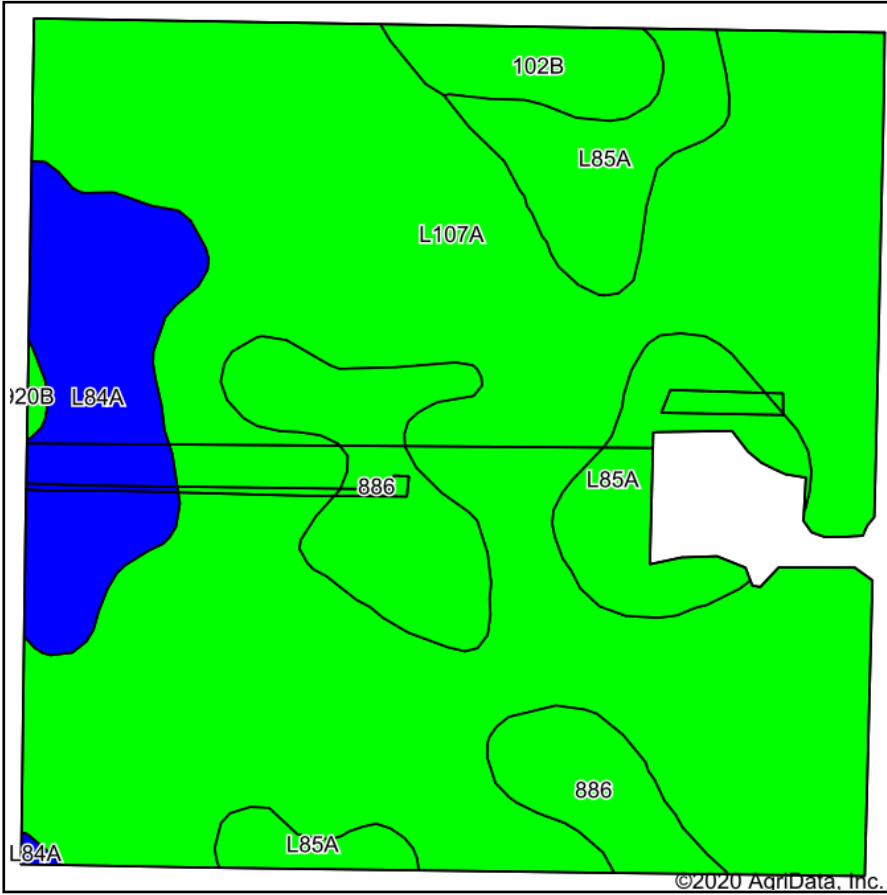

Soils data provided by USDA and NRCS.

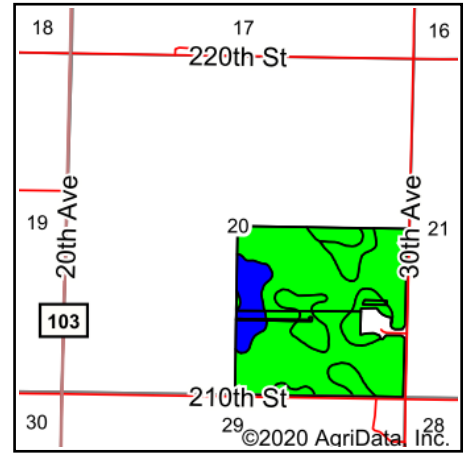

State: **Minnesota**  
 County: **Martin**  
 Location: **20-104N-33W**  
 Township: **Cedar**  
 Acres: **150.77**  
 Date: **9/23/2020**

**LANDPROZ.COM**  
 Agricultural & Recreational Real Estate / Auctions / Farm Management

Maps Provided By:  
  
 CUSTOMIZED ONLINE MAPPING  
 © AgriData, Inc. 2020 www.AgriDataInc.com



Area Symbol: MN091, Soil Area Version: 17										
Code	Soil Description	Acres	Percent of field	PI Legend	Non-Irr Class *c	Productivity Index	*n NCCPI Overall	*n NCCPI Corn	*n NCCPI Soybeans	
L107A	Canisteo-Glencoe complex, 0 to 2 percent slopes	103.98	69.0%		IIw	91	81	72	81	
L85A	Nicollet clay loam, 1 to 3 percent slopes	15.70	10.4%		Iw	99	82	81	82	
886	Nicollet-Crippin complex	13.72	9.1%		I	100	83	71	83	
L84A	Glencoe clay loam, 0 to 1 percent slopes	13.09	8.7%		IIIw	86	77	76	76	
102B	Clarion loam, 2 to 6 percent slopes	4.28	2.8%		Ile	95	84	80	84	
<b>Weighted Average</b>						<b>92.3</b>	<b>*n 81</b>	<b>*n 73.4</b>	<b>*n 80.9</b>	

\*n: The aggregation method is "Weighted Average using all components"

\*c: Using Capabilities Class Dominant Condition Aggregation Method

Soils data provided by USDA and NRCS.