

Soils Map

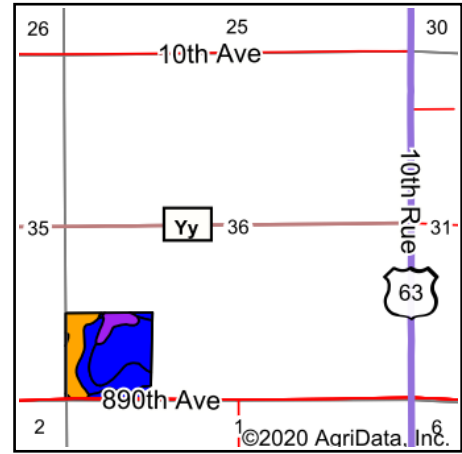
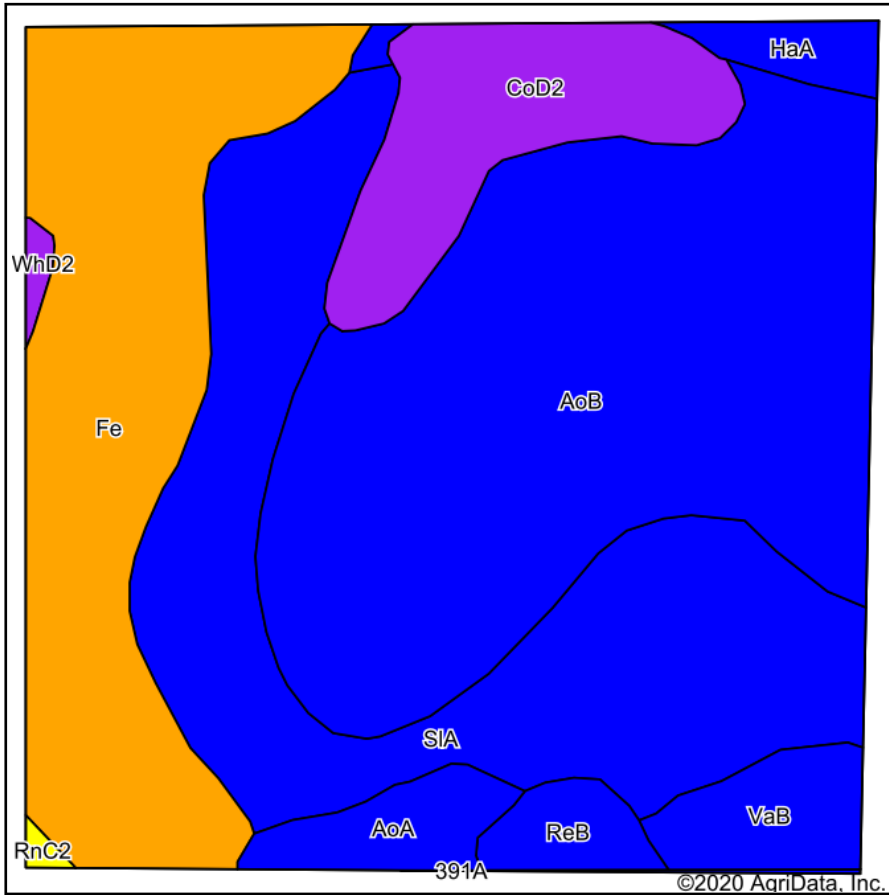

State: **Wisconsin**
 County: **St Croix**
 Location: **36-28N-17W**
 Township: **Rush River**
 Acres: **39.32**
 Date: **9/28/2020**

LANDPROZ.COM
 Agricultural & Recreational Real Estate / Auctions / Farm Management

Maps Provided By:

 CUSTOMIZED ONLINE MAPPING
 © AgriData, Inc. 2020 www.AgriDataInc.com



Soils data provided by USDA and NRCS.

Area Symbol: WI093, Soil Area Version: 20
 Area Symbol: WI109, Soil Area Version: 16

Code	Soil Description	Acres	Percent of field	Non-Irr Class Legend	Soil Drainage	Non-Irr Class *c	Irr Class *c	Alfalfa hay	Bluegrass white clover	Corn	Corn silage	Grass clover	Kentucky bluegrass	Oats	Orchardgrass alsike	Orchardgrass red clover
AoB	Antigo silt loam, 2 to 6 percent slopes	14.25	36.2%		Well drained	Ile										
SIA	Sattre silt loam, 0 to 2 percent slopes	9.81	24.9%		Well drained	Ils		4		90	15	6.6	3.6	75		
Fe	Fluvaquents	8.21	20.9%		Somewhat poorly drained	Illw										
CoD2	Chetek-Onamia complex, 12 to 20 percent slopes, eroded	3.26	8.3%		Somewhat excessively drained	Vle		2.6				5				
VaB	Vlasaty silt loam, 2 to 6 percent slopes	1.18	3.0%		Moderately well drained	Ile		4.9		130	21	8	4.5	80		
AoA	Antigo silt loam, 0 to 2 percent slopes	1.00	2.5%		Well drained	Ils										
ReB	Renova silt loam, 2 to 6 percent slopes	0.70	1.8%		Well drained	Ile		4.7		125	21	7.8	4.5	75		
HaA	Halder silt loam, 0 to 3 percent slopes	0.65	1.7%		Somewhat poorly drained	Ilw		3.7		85	14	7	3.9	70		
WhD2	Whalan silt loam, 12 to 25 percent slopes, eroded	0.13	0.3%		Well drained	Vle		3.2		80	13	5.5		55		



RnC2	Ritchey silt loam, 6 to 12 percent slopes, eroded	0.07	0.2%		Well drained	Ive		2.7		60	9	4.2		1.8	40			
816B2	Vlasaty silt loam, dissected, 2 to 6 percent slopes, moderately eroded	0.06	0.2%		Moderately well drained	Ile		5.2	3.8	130	18				75	4.6	4.8	
Weighted Average								1.5	*-	30.6	5.1	2.6		1.2	24		*-	*-

*n: The aggregation method is "Weighted Average using all components"

*c: Using Capabilities Class Dominant Condition Aggregation Method

Soils data provided by USDA and NRCS.