

Soils Map

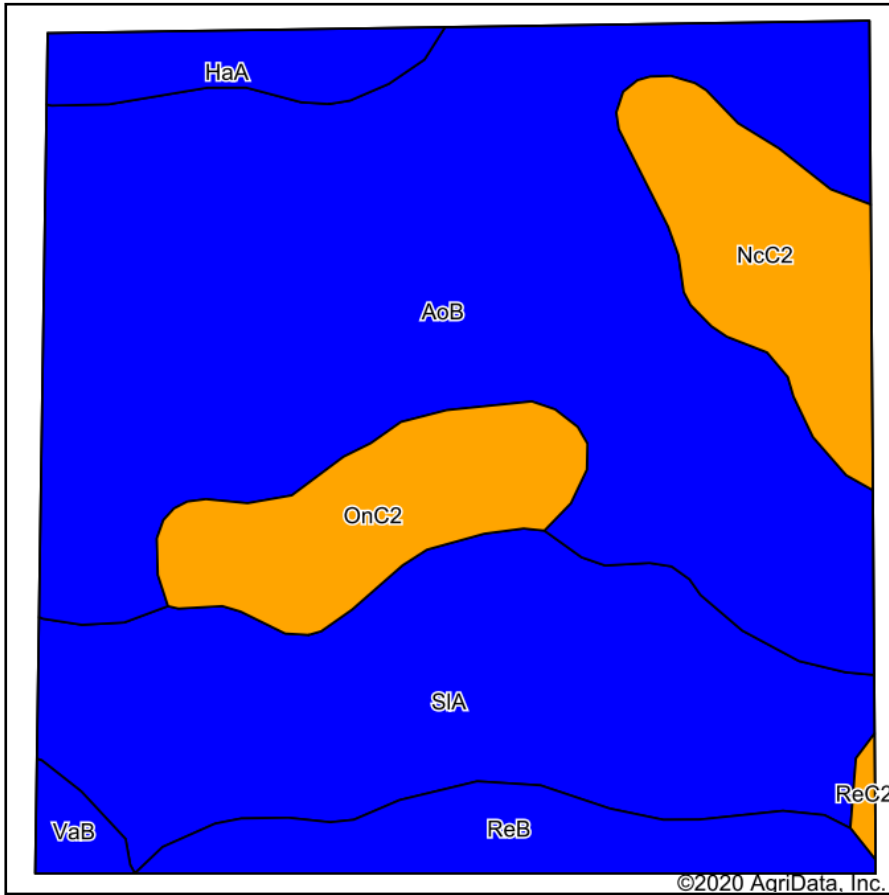

Soils data provided by USDA and NRCS.

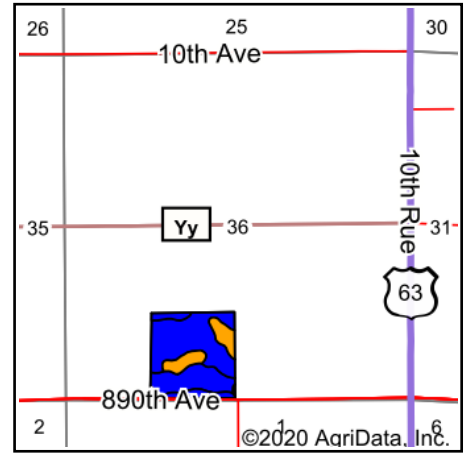

State: **Wisconsin**
 County: **St Croix**
 Location: **36-28N-17W**
 Township: **Rush River**
 Acres: **38.17**
 Date: **9/28/2020**

LANDPROZ.COM
 Agricultural & Recreational Real Estate / Auctions / Farm Management

Maps Provided By:

 CUSTOMIZED ONLINE MAPPING
 © AgriData, Inc. 2020 www.AgriDataInc.com



Area Symbol: WI109, Soil Area Version: 16

| Code | Soil Description | Acres | Percent of field | Non-Irr Class Legend | Soil Drainage | Non-Irr Class *c | Alfalfa hay | Corn | Corn silage | Grass clover | Kentucky bluegrass | Oats | Red clover hay | Soybeans | Winter wheat | *n NCCPI Overall | *n NCCPI Corn | *n NCCPI Small Grains | *n So |
|------|---|-------|------------------|----------------------|-------------------------|------------------|-------------|------|-------------|--------------|--------------------|------|----------------|----------|--------------|------------------|---------------|-----------------------|-------|
| AoB | Antigo silt loam, 2 to 6 percent slopes | 18.58 | 48.7% | | Well drained | Ile | | | | | | | | | | 56 | 56 | 51 | |
| SIA | Sattre silt loam, 0 to 2 percent slopes | 9.53 | 25.0% | | Well drained | Ils | 4 | 90 | 15 | 6.6 | 3.6 | 75 | | 30 | 45 | 71 | 71 | 55 | |
| OnC2 | Onamia-Antigo complex, 6 to 12 percent slopes, eroded | 2.92 | 7.6% | | Well drained | Ille | 3.5 | 75 | 12 | 6.4 | 3.4 | 65 | | 25 | 40 | 52 | 52 | 39 | |
| NcC2 | Nickin silt loam, 6 to 12 percent slopes, eroded | 2.86 | 7.5% | | Well drained | Ille | 3.6 | 85 | 14 | 5.7 | 2.9 | 60 | | 28 | 38 | 64 | 64 | 51 | |
| ReB | Renova silt loam, 2 to 6 percent slopes | 2.43 | 6.4% | | Well drained | Ile | 4.7 | 125 | 21 | 7.8 | 4.5 | 75 | | 41 | 45 | 89 | 89 | 60 | |
| HaA | Halder silt loam, 0 to 3 percent slopes | 1.34 | 3.5% | | Somewhat poorly drained | Ilw | 3.7 | 85 | 14 | 7 | 3.9 | 70 | 3.7 | 28 | 42 | 60 | 60 | 40 | |
| VaB | Vlasaty silt loam, 2 to 6 percent slopes | 0.39 | 1.0% | | Moderately well drained | Ile | 4.9 | 130 | 21 | 8 | 4.5 | 80 | | 43 | 48 | 79 | 79 | 57 | |



| | | | | | | | | | | | | | | | | | | |
|-------------------------|--|------|------|--|--------------|------|----------|-------------|------------|------------|------------|-------------|------------|-------------|-------------|----------------|----------------|----------------|
| ReC2 | Renova silt loam, 6 to 12 percent slopes, eroded | 0.12 | 0.3% | | Well drained | Ille | 4.3 | 115 | 19 | 7.4 | 4.1 | 65 | | 38 | 41 | 83 | 83 | 54 |
| Weighted Average | | | | | | | 2 | 47.2 | 7.8 | 3.4 | 1.9 | 36.4 | 0.1 | 15.7 | 22.1 | *n 62.6 | *n 62.6 | *n 51.3 |

*n: The aggregation method is "Weighted Average using all components"

*c: Using Capabilities Class Dominant Condition Aggregation Method

Soils data provided by USDA and NRCS.