

# Soils Map

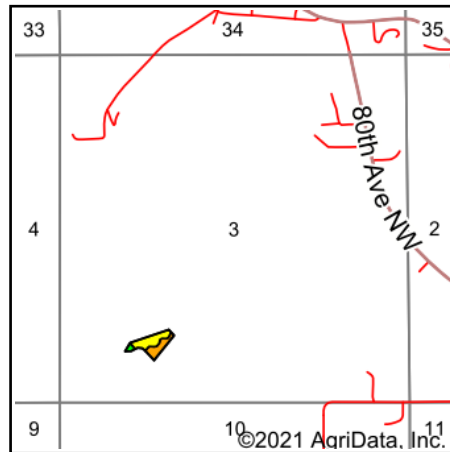

State: **Minnesota**  
 County: **Olmsted**  
 Location: **3-107N-15W**  
 Township: **Kalmar**  
 Acres: **3.33**  
 Date: **4/18/2021**

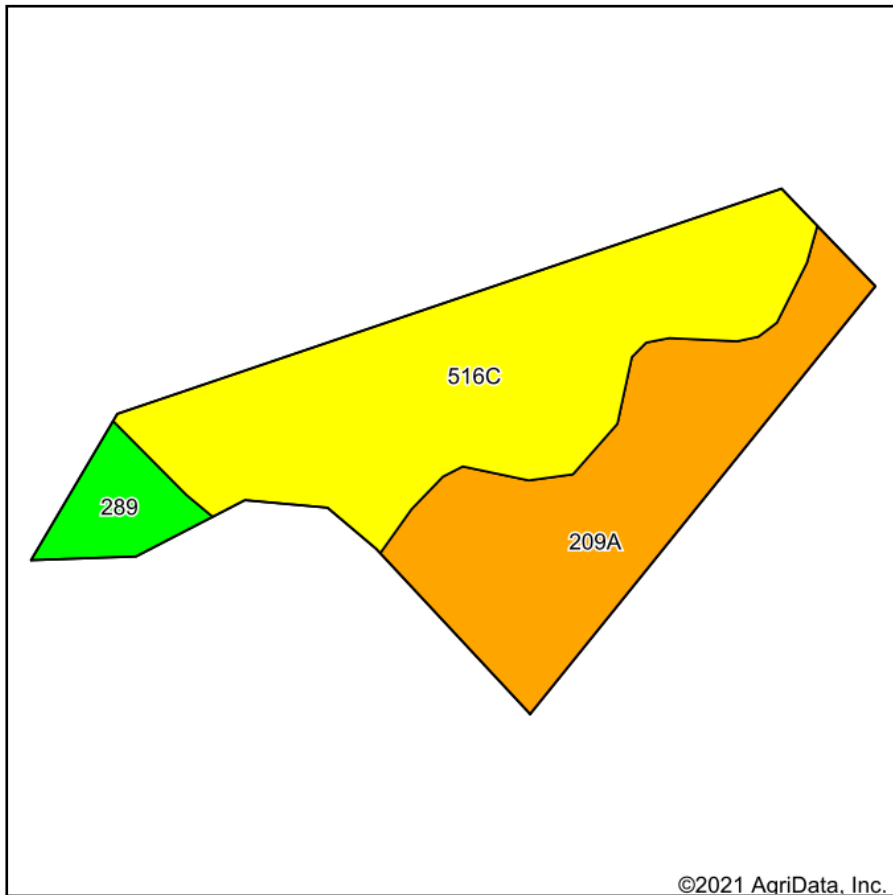

Soils data provided by USDA and NRCS.

Area Symbol: MN109, Soil Area Version: 15

Code	Soil Description	Acres	Percent of field	PI Legend	Non-Irr Class *c	Productivity Index	*n NCCPI Overall	*n NCCPI Corn	*n NCCPI Soybeans
516C	Dowagiac sandy loam, 6 to 12 percent slopes	1.83	55.0%		IIIe	61	71	71	55
209A	Kegonsa silt loam, 0 to 2 percent slopes	1.28	38.4%		IIs	74	70	70	56
289	Radford silt loam	0.22	6.6%		IIw	95	82	75	82
<b>Weighted Average</b>						<b>68.2</b>	<b>*n 71.3</b>	<b>*n 70.9</b>	<b>*n 57.2</b>

\*n: The aggregation method is "Weighted Average using all components"

\*c: Using Capabilities Class Dominant Condition Aggregation Method

Soils data provided by USDA and NRCS.