

Soils Map

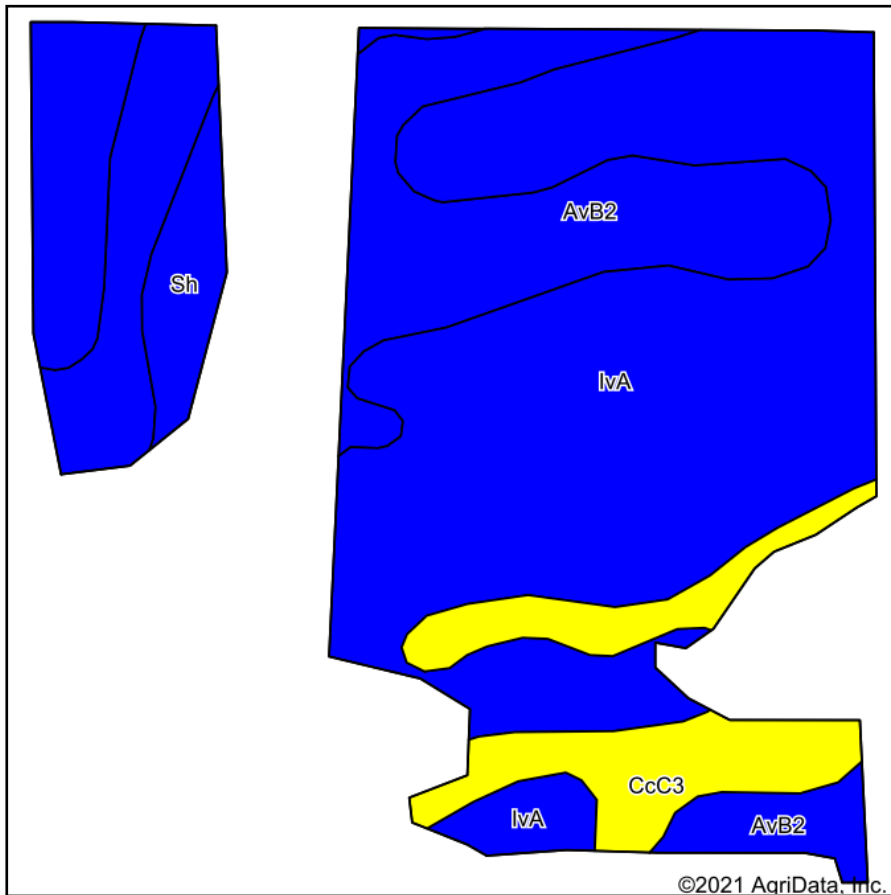

Soils data provided by USDA and NRCS.

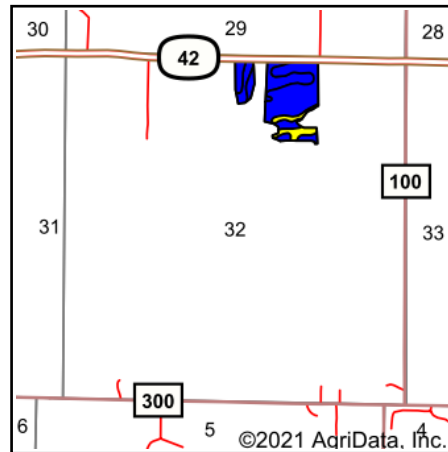

State: **Indiana**
 County: **Clay**
 Location: **32-12N-6W**
 Township: **Jackson**
 Acres: **24.23**
 Date: **4/28/2021**

LANDPROZ.COM
 Agricultural & Recreational Real Estate / Auctions / Farm Management



Area Symbol: IN021, Soil Area Version: 24

Code	Soil Description	Acres	Percent of field	Non-Irr Class Legend	Non-Irr Class *c	Alfalfa hay	Corn	Grass legume hay	Pasture	Soybeans	Tobacco	Winter wheat	*n NCCPI Overall	*n NCCPI Corn	*n NCCPI Small Grains	*n NCCPI Soybeans	*n NCCPI Cotton
IvA	Iva silt loam, 0 to 2 percent slopes	14.18	58.5%		Ilw		164	5	11	54		73	89	86	77	88	75
AvB2	Ava silt loam, 2 to 6 percent slopes, eroded	6.49	26.8%		Ile	5	131	4	9	46		59	51	46	51	35	50
CcC3	Cincinnati silt loam, Wabash Lowland, 6 to 12 percent slopes, severely eroded	2.60	10.7%		Ive	4	102	3	7	36	130	46	36	36	28	24	34
Sh	Shoals silt loam, 0 to 2 percent slopes, frequently flooded, very brief duration	0.96	4.0%		Ilw		129		1	42		3	81	66	52	81	0
Weighted Average						1.8	147.1	4.3	9.6	49.5	13.9	63.6	*n 72.8	*n 69.1	*n 63.8	*n 66.7	*n 60.9

*n: The aggregation method is "Weighted Average using all components"

*c: Using Capabilities Class Dominant Condition Aggregation Method

Soils data provided by USDA and NRCS.