

# Soils Map

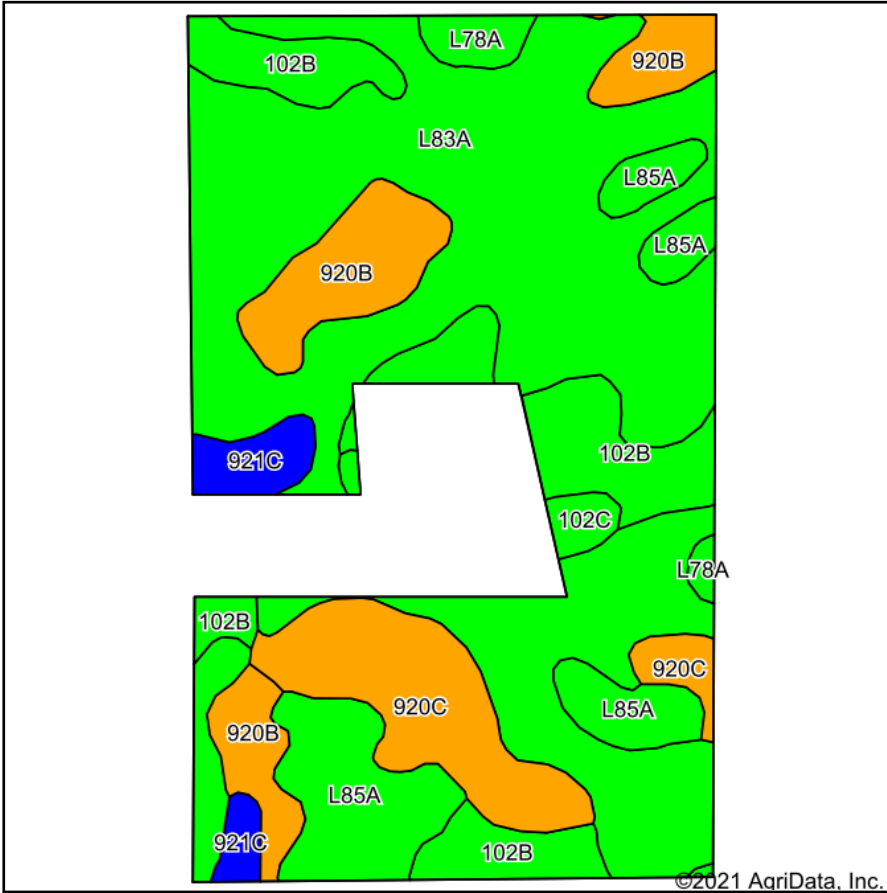

Soils data provided by USDA and NRCS.

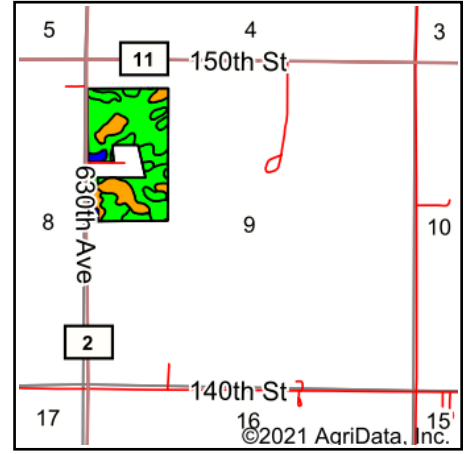

State: **Minnesota**  
 County: **Freeborn**  
 Location: **9-101N-23W**  
 Township: **Mansfield**  
 Acres: **55.06**  
 Date: **10/20/2021**

**LANDPROZ.COM**  
 Agricultural & Recreational Real Estate / Auctions / Farm Management

Maps Provided By:  
  
 CUSTOMIZED ONLINE MAPPING  
 © AgriData, Inc. 2021 www.AgriDataInc.com



Area Symbol: MN047, Soil Area Version: 16

Code	Soil Description	Acres	Percent of field	PI Legend	Non-Irr Class *c	Productivity Index	*n NCCPI Overall	*n NCCPI Corn	*n NCCPI Soybeans
L83A	Webster clay loam, 0 to 2 percent slopes	28.92	52.5%		IIw	93	83	78	82
102B	Clarion loam, 2 to 6 percent slopes	6.79	12.3%		Ile	95	84	80	84
L85A	Nicollet clay loam, 1 to 3 percent slopes	5.76	10.5%		Iw	99	82	81	82
920C	Clarion-Storden-Pilot Grove complex, 6 to 10 percent slopes, moderately eroded	5.34	9.7%		IIIe	73	66	64	63
920B	Clarion-Estherville complex, 2 to 6 percent slopes	5.25	9.5%		Ile	76	70	68	65
921C	Clarion-Storden complex, 6 to 10 percent slopes, moderately eroded	1.48	2.7%		IIIe	87	73	70	73
L78A	Canisteo clay loam, 0 to 2 percent slopes	0.90	1.6%		IIw	93	81	71	81
102C	Clarion loam, 6 to 10 percent slopes	0.62	1.1%		IIIe	92	81	77	81
<b>Weighted Average</b>					<b>2.03</b>	<b>90.1</b>	<b>*n 79.8</b>	<b>*n 75.9</b>	<b>*n 78.5</b>

\*n: The aggregation method is "Weighted Average using all components"

\*c: Using Capabilities Class Dominant Condition Aggregation Method

Soils data provided by USDA and NRCS.