

# Soils Map

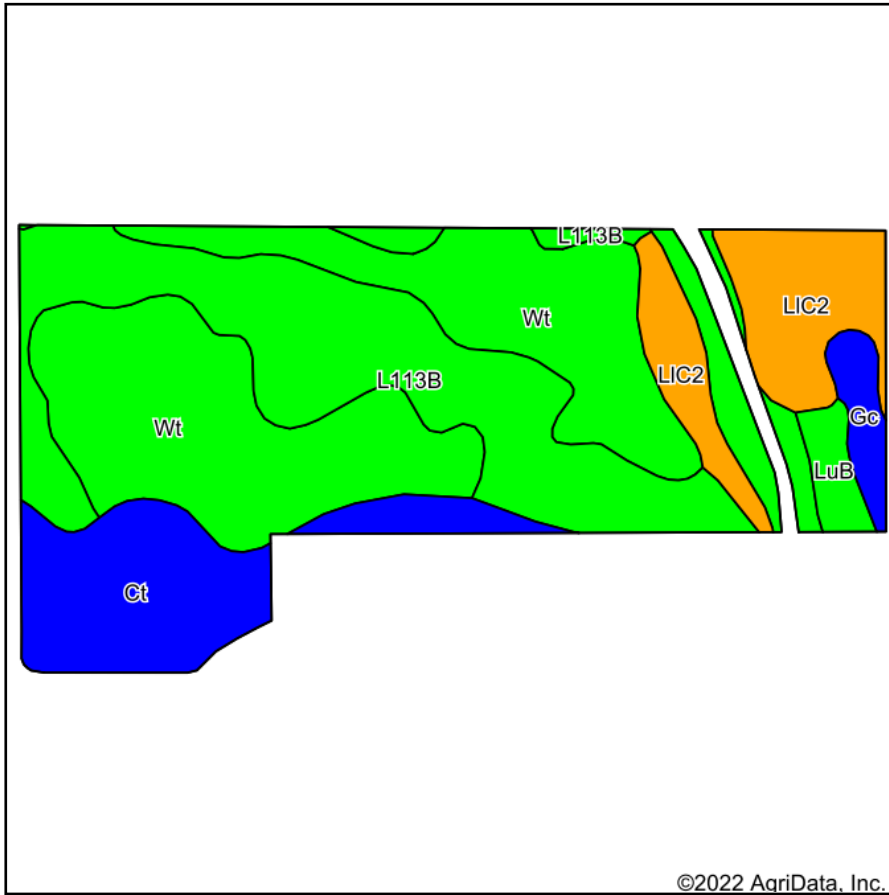

Soils data provided by USDA and NRCS.

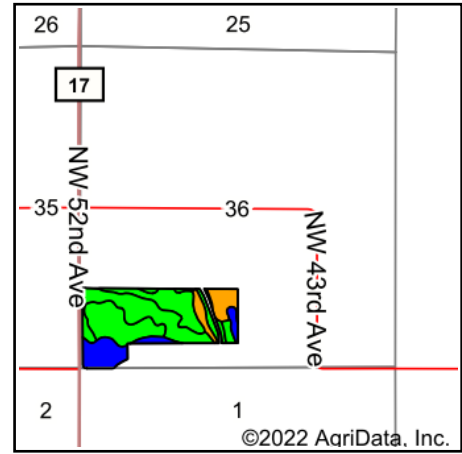

State: **Minnesota**  
 County: **Steele**  
 Location: **36-108N-21W**  
 Township: **Deerfield**  
 Acres: **60.2**  
 Date: **12/19/2022**

Maps Provided By:  
  
 CUSTOMIZED ONLINE MAPPING  
 © AgriData, Inc. 2021 www.AgriDataInc.com



Area Symbol: MN147, Soil Area Version: 18

Code	Soil Description	Acres	Percent of field	PI Legend	Non-Irr Class *c	Productivity Index	*n NCCPI Overall	*n NCCPI Corn	*n NCCPI Soybeans
Wt	Webster clay loam, 0 to 2 percent slopes	25.08	41.7%		llw	93	82	78	82
L113B	Reedslake-Le Sueur complex, 1 to 6 percent slopes	16.62	27.6%		lle	98	81	77	80
Ct	Colo silty clay loam, occasionally flooded	8.76	14.6%		llw	81	73	62	71
LIC2	Lester loam, 6 to 10 percent slopes, moderately eroded	7.10	11.8%		llle	76	77	77	69
Gc	Glencoe clay loam, 0 to 1 percent slopes	1.43	2.4%		lllw	86	77	76	76
LuB	Le Sueur clay loam, 2 to 4 percent slopes	1.21	2.0%		lw	98	91	91	83
<b>Weighted Average</b>						<b>2.12</b>	<b>*n 79.9</b>	<b>*n 75.5</b>	<b>*n 78.2</b>

\*n: The aggregation method is "Weighted Average using all components"

\*c: Using Capabilities Class Dominant Condition Aggregation Method

Soils data provided by USDA and NRCS.