

Soils Map

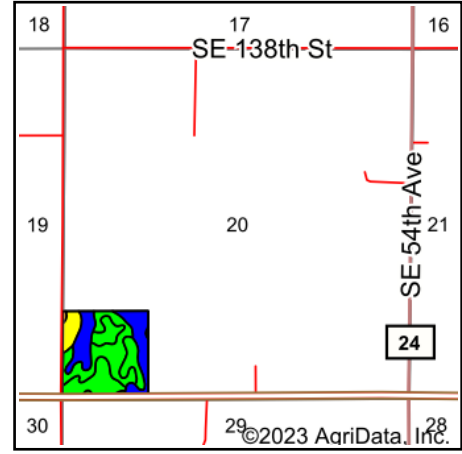

State: **Minnesota**
 County: **Steele**
 Location: **20-105N-19W**
 Township: **Blooming Prairie**
 Acres: **38.22**
 Date: **1/5/2023**

Maps Provided By:

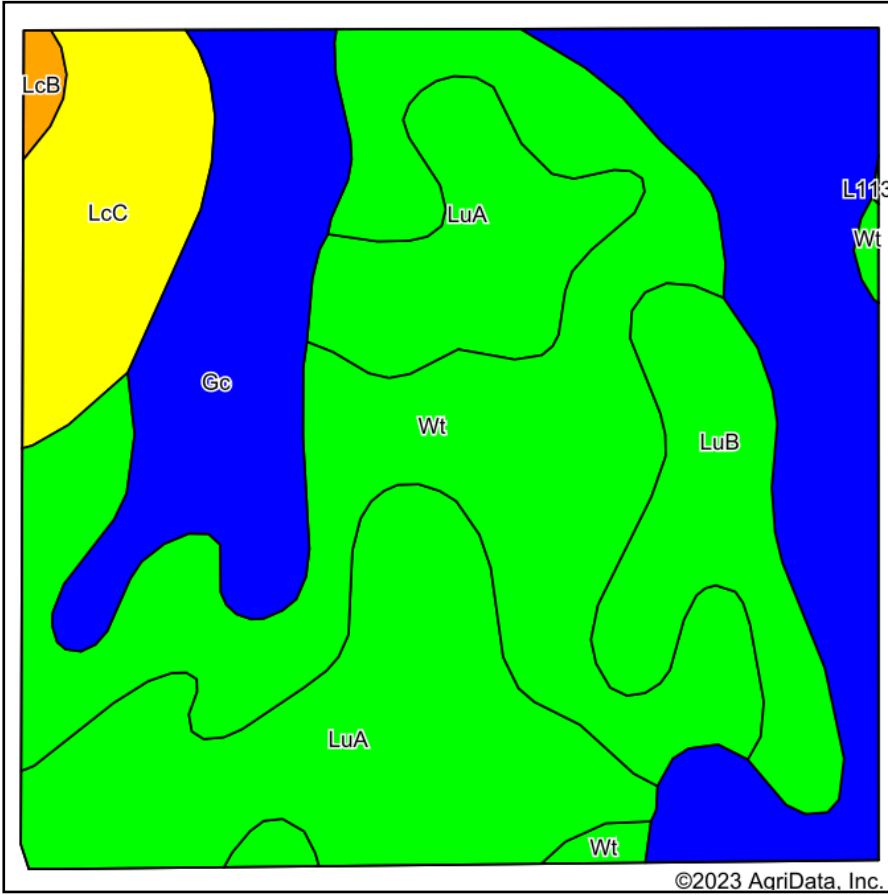





 CUSTOMIZED ONLINE MAPPING
 © AgriData, Inc. 2021 www.AgriDataInc.com



Soils data provided by USDA and NRCS.

©2023 AgriData, Inc.

Area Symbol: MN147, Soil Area Version: 18

Code	Soil Description	Acres	Percent of field	PI Legend	Non-Irr Class *c	Productivity Index	*n NCCPI Overall	*n NCCPI Corn	*n NCCPI Soybeans
Wt	Webster clay loam, 0 to 2 percent slopes	11.38	29.8%		IIw	93	82	78	82
Gc	Glencoe clay loam, 0 to 1 percent slopes	11.11	29.1%		IIIw	86	77	76	76
LuA	Le Sueur loam, 1 to 3 percent slopes	9.23	24.1%		Iw	97	90	90	84
LuB	Le Sueur clay loam, 2 to 4 percent slopes	3.25	8.5%		Iw	98	91	91	83
LcC	Lamont sandy loam, 6 to 12 percent slopes	3.03	7.9%		IVe	65	70	69	47
LcB	Lamont sandy loam, 2 to 6 percent slopes	0.22	0.6%		IIIe	72	70	70	48
Weighted Average					2.13	90	*n 82.2	*n 80.7	*n 77.9

*n: The aggregation method is "Weighted Average using all components"

*c: Using Capabilities Class Dominant Condition Aggregation Method

Soils data provided by USDA and NRCS.