

Soils Map

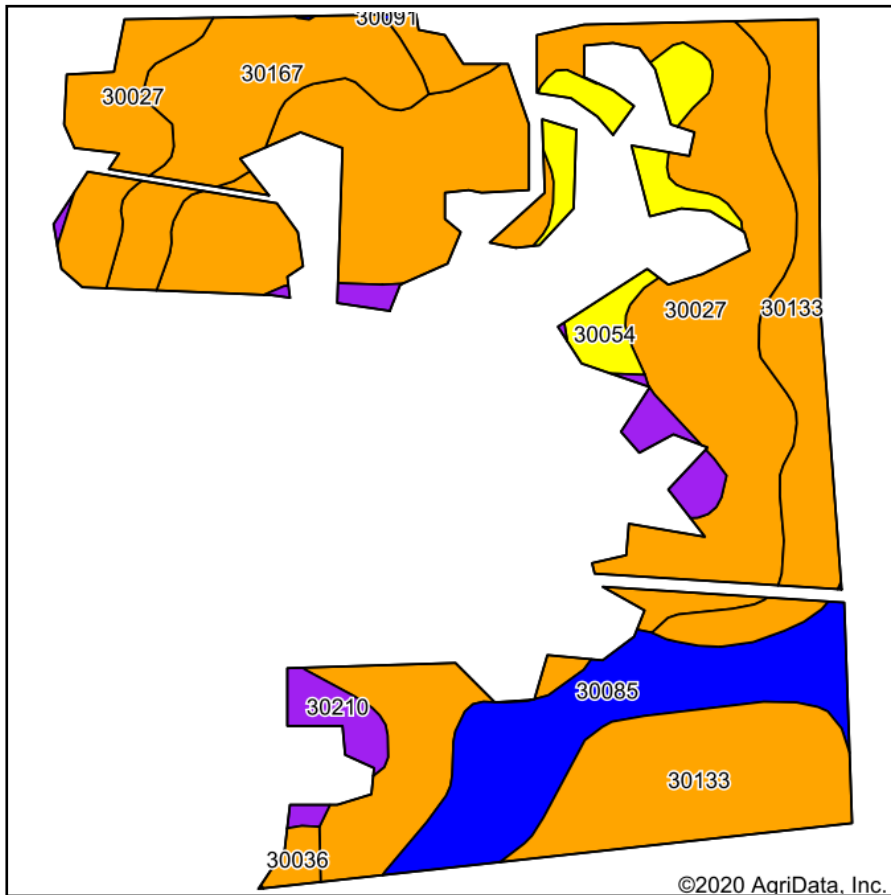

Soils data provided by USDA and NRCS.

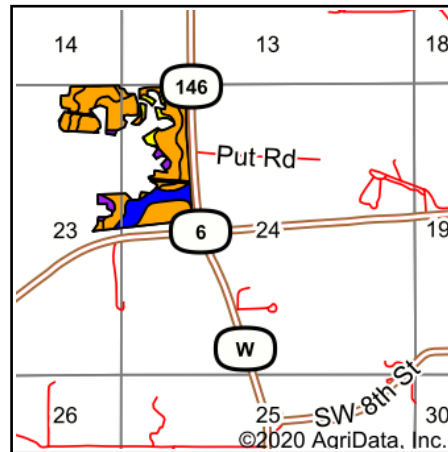

State: **Missouri**
 County: **Grundy**
 Location: **23-61N-25W**
 Township: **Madison**
 Acres: **68.3**
 Date: **7/27/2020**

LANDPROZ.COM
 Agricultural & Recreational Real Estate / Auctions / Farm Management

Maps Provided By:

 CUSTOMIZED ONLINE MAPPING
 © AgriData, Inc. 2020 www.AgriDataInc.com



Area Symbol: MO079. Soil Area Version: 22															
Code	Soil Description	Acres	Percent of field	Non-Irr Class Legend	Non-Irr Class *c	Alfalfa hay	Caucasian bluestem	Common bermudagrass	Orchardgrass red clover	Tall fescue	Warm season grasses	*n NCCPI Overall	*n NCCPI Corn	*n NCCPI Small Grains	*n NCCPI Soybeans
30027	Armstrong clay loam, 5 to 9 percent slopes, moderately eroded	30.94	45.3%		IIIe							53	53	34	39
30133	Lamoni clay loam, 5 to 9 percent slopes, moderately eroded	15.28	22.4%		IIIe							57	57	39	50
30085	Grundy silt loam, 2 to 5 percent slopes	8.50	12.4%		Ile							69	69	49	63
30167	Pershing silt loam, 2 to 5 percent slopes	6.92	10.1%		IIIe							73	73	45	62
30054	Gara clay loam, 9 to 14 percent slopes, eroded	3.44	5.0%		IVe							61	61	41	46
30210	Vanmeter flaggy silty clay loam, 9 to 14 percent slopes	2.70	4.0%		VIIe	4	7	4	6	5	7	29	25	29	21



30036	Armstrong loam, 5 to 9 percent slopes	0.52	0.8%		Ille	5	8	7	8	7	8	52	49	42	52
Weighted Average						0.2	0.3	0.2	0.3	0.3	0.3	*n 57.4	*n 57.2	*n 38.3	*n 46.5

*n: The aggregation method is "Weighted Average using major components"

*c: Using Capabilities Class Dominant Condition Aggregation Method

Soils data provided by USDA and NRCS.