

Soils Map

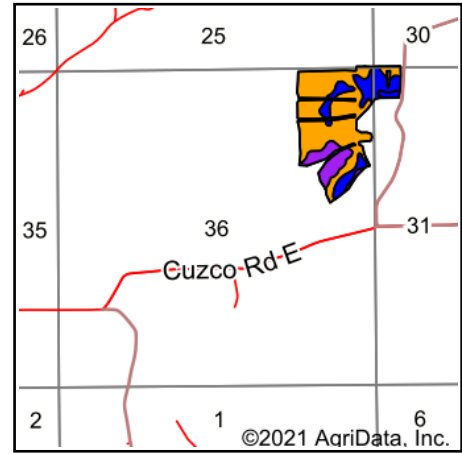
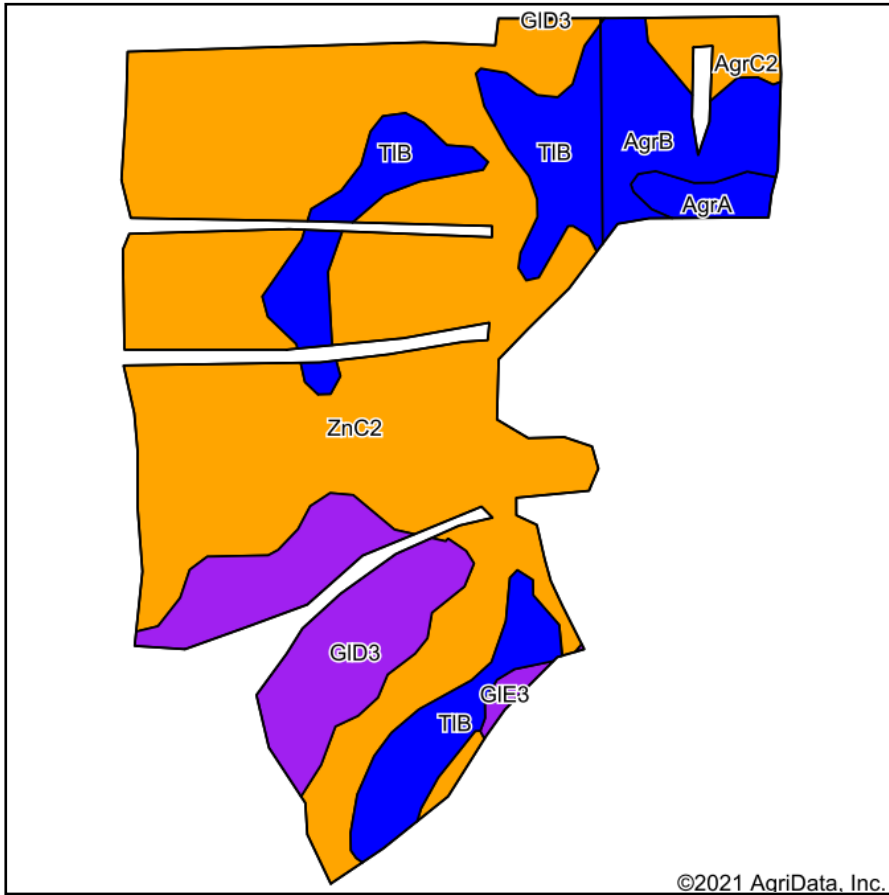

State: **Indiana**
 County: **Dubois**
 Location: **36-1N-3W**
 Township: **Columbia**
 Acres: **51.6**
 Date: **1/5/2021**

LANDPROZ.COM
 Agricultural & Recreational Real Estate / Auctions / Farm Management

Maps Provided By:

 CUSTOMIZED ONLINE MAPPING
 © AgriData, Inc. 2020 www.AgriDataInc.com



Soils data provided by USDA and NRCS.

©2021 AgriData, Inc.

Code	Soil Description	Acres	Percent of field	Non-Irr Class Legend	Non-Irr Class *c	Alfalfa hay	Burley tobacco	Corn	Grass legume hay	Pasture	Soybeans	Winter wheat	*n NCCPI Overall	*n NCCPI Corn	*n NCCPI Small Grains	*n NCCPI Soybeans	*n NCCPI Cotton
ZnC2	Apalona-Zanesville silt loams, 6 to 12 percent slopes, eroded	32.26	62.5%		Ille	6		117	4	8	41	53	48	47	48	34	24
TIB	Zanesville silt loam, 2 to 6 percent slopes	7.40	14.3%		Ile		2934	133	4	9	52	61	67	61	66	47	30
GID3	Gilpin silt loam, 12 to 18 percent slopes, severely eroded	6.26	12.1%		Vle			70	2	5	25	35	38	38	33	20	16
AgrB	Apalona-Zanesville silt loams, 2 to 6 percent slopes	3.38	6.6%		Ile	6		134	5	9	47	60	66	61	66	51	18
AgrC2	Apalona-Zanesville silt loams, 6 to 12 percent slopes, eroded	1.18	2.3%		Ille	6		117	4	8	41	53	48	47	48	34	24
AgrA	Apalona silt loam, 0 to 2 percent slopes	0.84	1.6%		Ilw			135	5	9	47	61	65	61	65	51	48



GIE3	Gilpin silt loam, 18 to 25 percent slopes, severely eroded	0.28	0.5%		Vle				2	4			32	32	24		16	14
Weighted Average						4.3	420.8	114.4	3.8	7.8	40.9	52.3	*n 50.9	*n 49	*n 50.1		*n 35.5	*n 23.8

*n: The aggregation method is "Weighted Average using all components"

*c: Using Capabilities Class Dominant Condition Aggregation Method

Soils data provided by USDA and NRCS.