

# Soils Map

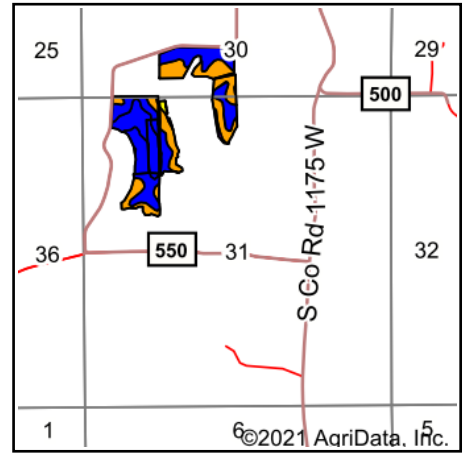

State: **Indiana**  
 County: **Orange**  
 Location: **31-1N-2W**  
 Township: **Jackson**  
 Acres: **54.98**  
 Date: **1/5/2021**

**LANDPROZ.COM**  
 Agricultural & Recreational Real Estate / Auctions / Farm Management

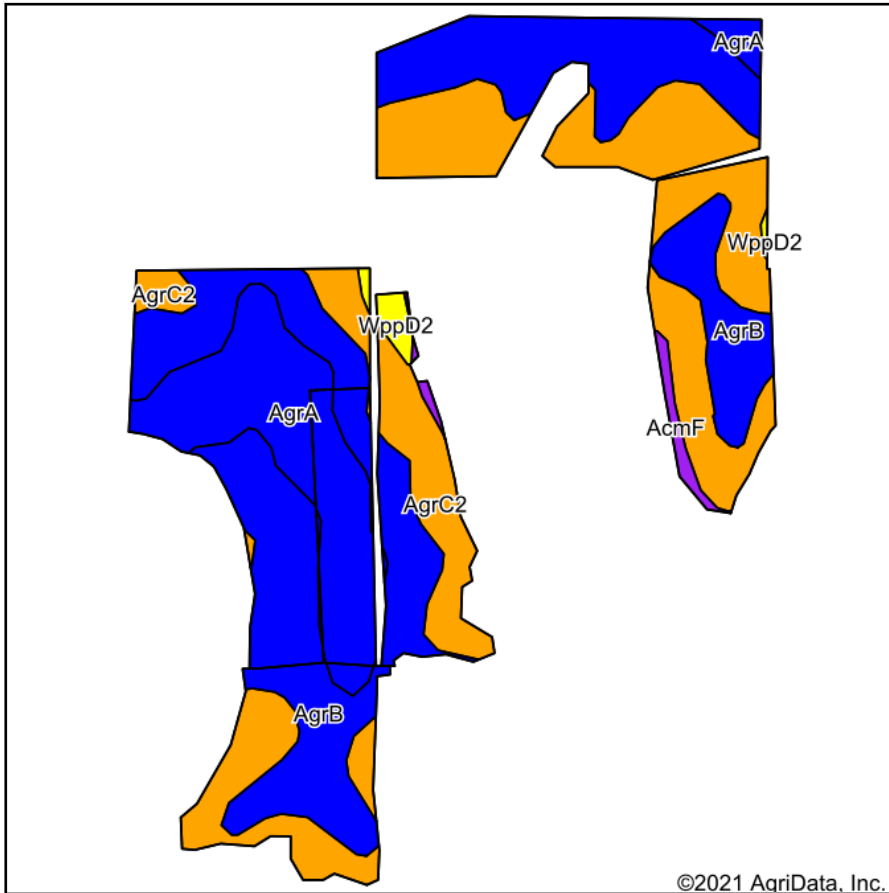

Soils data provided by USDA and NRCS.

©2021 AgriData, Inc.

Code	Soil Description	Acres	Percent of field	Non-Irr Class Legend	Non-Irr Class *c	Alfalfa hay	Corn	Grass legume hay	Pasture	Soybeans	Winter wheat	*n NCCPI Overall	*n NCCPI Corn	*n NCCPI Small Grains	*n NCCPI Soybeans	*n NCCPI Cotton
AgrB	Apalona-Zanesville silt loams, 2 to 6 percent slopes	24.70	44.9%		Ile	6	134	5	9	47	60	66	61	66	51	18
AgrC2	Apalona-Zanesville silt loams, 6 to 12 percent slopes, eroded	19.84	36.1%		IIle	6	117	4	8	41	53	48	47	48	34	24
AgrA	Apalona silt loam, 0 to 2 percent slopes	9.22	16.8%		IIw		135	5	9	47	61	65	61	65	51	48
AcmF	Adyeville-Wellston silt loams, 18 to 50 percent slopes	0.63	1.1%		VIIe		4			2	1	22	21	18	13	17
WppD2	Wellston-Adyeville-Ebal silt loams, 12 to 18 percent slopes, eroded	0.59	1.1%		IVe		94	3	6	33	38	51	51	49	40	42
<b>Weighted Average</b>						<b>4.9</b>	<b>126.1</b>	<b>4.6</b>	<b>8.5</b>	<b>44.2</b>	<b>56.7</b>	<b>*n 58.7</b>	<b>*n 55.4</b>	<b>*n 58.6</b>	<b>*n 44.3</b>	<b>*n 25.4</b>

\*n: The aggregation method is "Weighted Average using all components"

\*c: Using Capabilities Class Dominant Condition Aggregation Method

Soils data provided by USDA and NRCS.