

# Soils Map

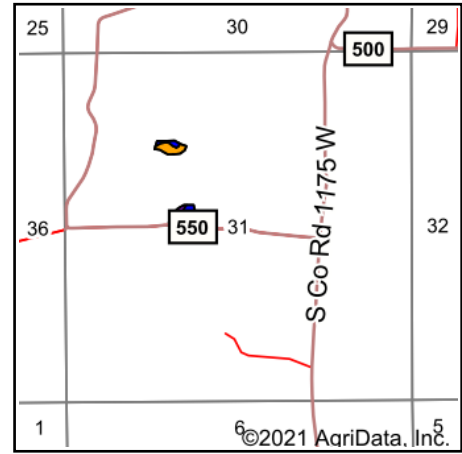
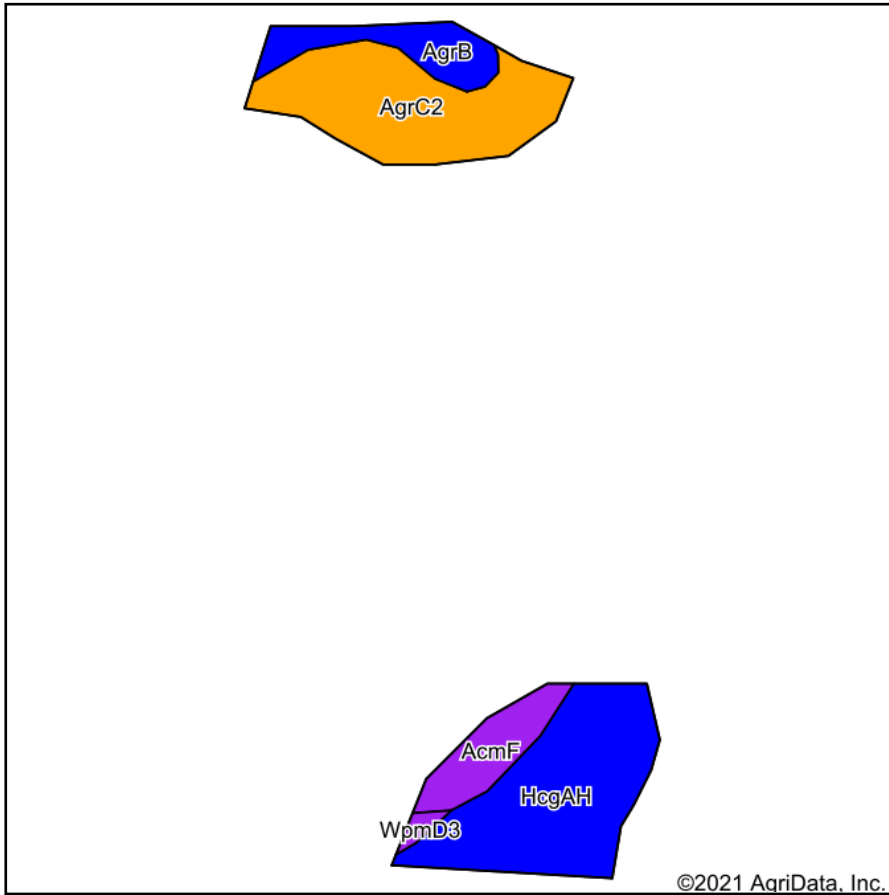

State: **Indiana**  
 County: **Orange**  
 Location: **31-1N-2W**  
 Township: **Jackson**  
 Acres: **3.55**  
 Date: **1/11/2021**

**LANDPROZ.COM**  
 Agricultural & Recreational Real Estate / Auctions / Farm Management

Maps Provided By:  
  
 CUSTOMIZED ONLINE MAPPING  
 © AcriData, Inc. 2020 www.AcriDataInc.com



Code	Soil Description	Acres	Percent of field	Non-Irr Class Legend	Non-Irr Class *c	Alfalfa hay	Corn	Grass legume hay	Pasture	Soybeans	Winter wheat	*n NCCPI Overall	*n NCCPI Corn	*n NCCPI Small Grains	*n NCCPI Soybeans	*n NCCPI Cotton
HcgAH	Haymond silt loam, 0 to 2 percent slopes, frequently flooded, brief duration	1.46	41.1%		llw		120			42		94	94	52	78	70
AgrC2	Apalona-Zanesville silt loams, 6 to 12 percent slopes, eroded	1.29	36.3%		llle	6	117	4	8	41	53	48	47	48	34	24
AgrB	Apalona-Zanesville silt loams, 2 to 6 percent slopes	0.41	11.5%		lle	6	134	5	9	47	60	66	61	66	51	18
AcmF	Adyeville-Wellston silt loams, 18 to 50 percent slopes	0.39	11.0%		Vlle		4			2	1	22	21	18	13	17
<b>Weighted Average</b>						<b>2.9</b>	<b>107.8</b>	<b>2</b>	<b>3.9</b>	<b>37.8</b>	<b>26.3</b>	<b>*n 66.1</b>	<b>*n 65.1</b>	<b>*n 48.4</b>	<b>*n 51.8</b>	<b>*n 41.5</b>

\*n: The aggregation method is "Weighted Average using all components"

\*c: Using Capabilities Class Dominant Condition Aggregation Method

Soils data provided by USDA and NRCS.